

Section A-A

Specifications:

Current Rating:1.5A AC/DC

Voltage Rating:30V AC/DC

Contact Resistance:30m ohm. Max. ^{25m}

Insulation Resistance:1,000M ohm. min.

Withstanding Voltage:500V AC For One Minute ^{750V}

Operating Temperature Range:-40°C ~ +105°C

^{-55°C~85°C}

Material and Finish

Insulator:PBT (UL94V-0)

Insulator Color:Black

Contact:Brass

Plating:30u" Gold Plated on Contact Area,

Tin Plated on Solder Tail. ^{Gold Flash and Tin Over Nickel Plated}

Shell:Brass,Nickel Plated

Back Cover:Brass,Nickel Plated

SPCC

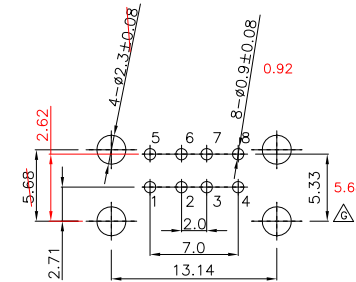
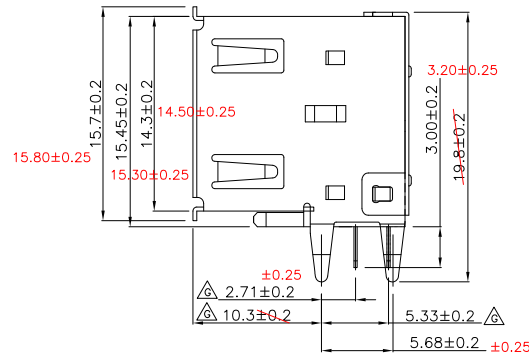
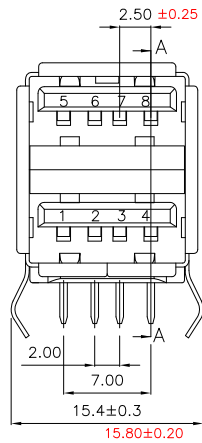
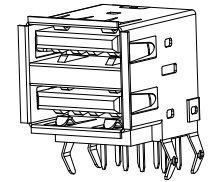

PCB layout

Note: Dimension in red represents old dimension

RoHS Compliant

				DRAWN:	GENERAL TOLERANCE: .X=±0.20 .XX=±0.15	<h1 style="text-align: center; color: red;">CnC Tech</h1> <p style="text-align: center;">Industrial Cable and Connector Technology</p>	
				CHECKED:	UNIT: MM		
					SCALE:1:1	PART NO: 1002-004-01010	<p style="text-align: center; font-size: 24px;">A4</p>
	05-FEB-2020			APPROVAL:	SHEET: 1 / 2		
REV	DATE	FILE	BY		PROJECTION:		